

SHILOH

RESTING PLACE OF THE ARK OF THE LORD
BEFORE BEING BROUGHT TO JERUSALEM

SECTION 35

SHARON MEMORIAL PARK

SHARON, MASS.

November 1971 Scale: 1"=20' Plan No. 280-306

Harry E. Fraser
Landscape Archt.
Norwood, Mass.

B6

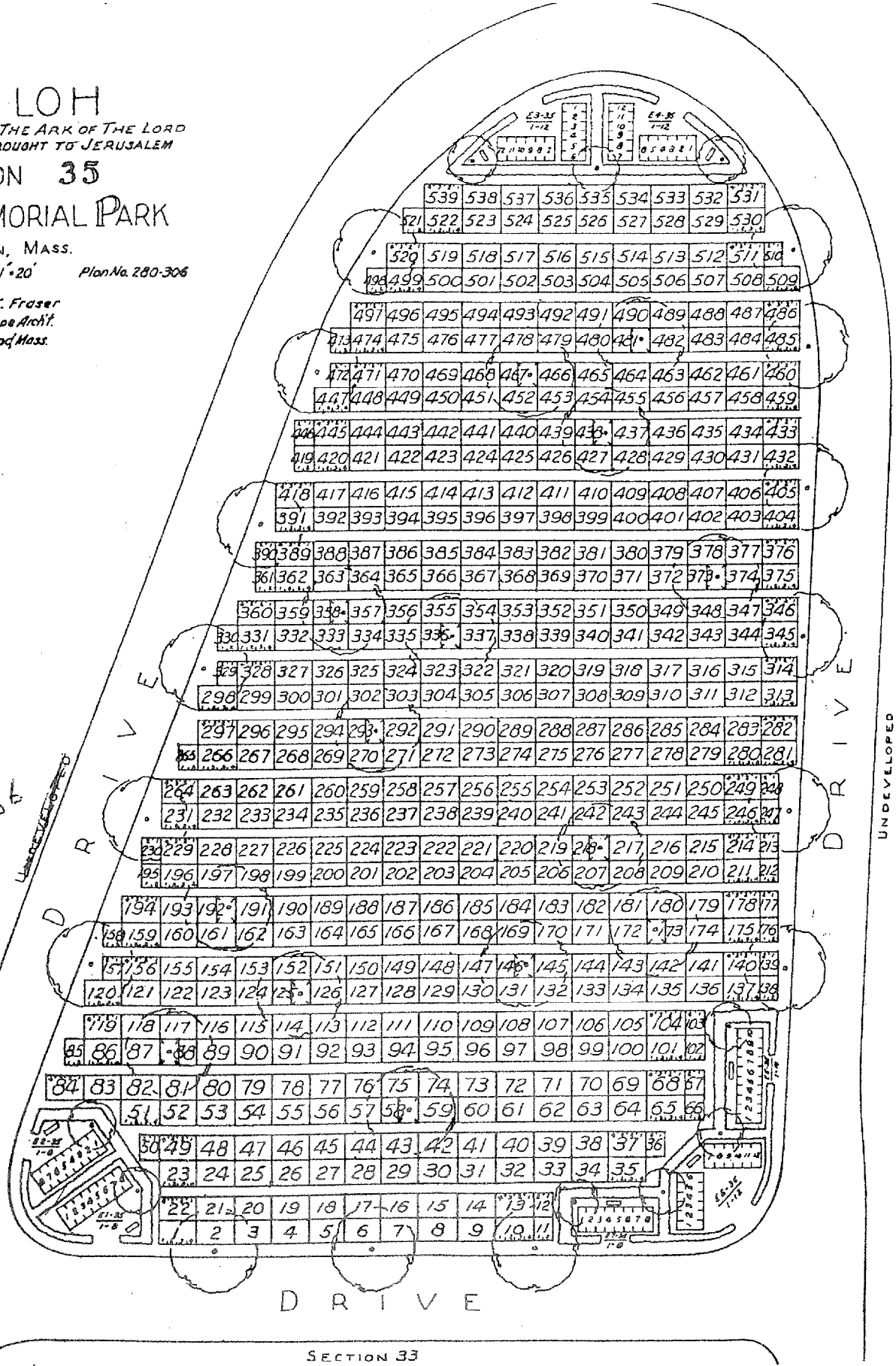

DRIVE