

SEC. 29
HEBRON

GILEAD - SECTION 29

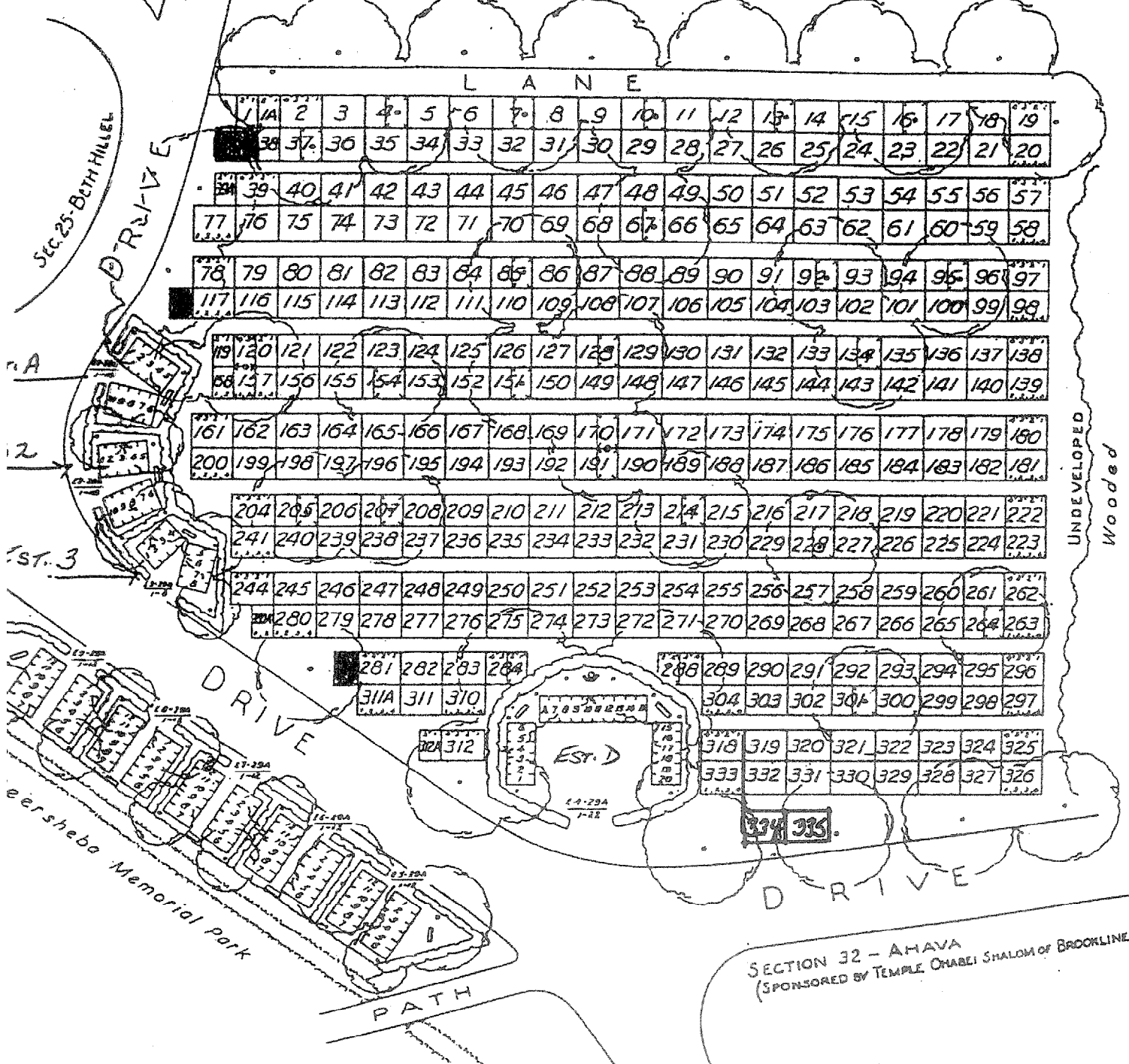

UNDEVELOPED
Wooded

GILEAD

BIRTHPLACE OF THE PROPHET ELIJAH
SPONSORED BY BETH EL TEMPLE CENTER OF BELMONT, MASS.

SECTION 29A
SHARON MEMORIAL PARK
SHARON, MASS.

N.B.
Lots numbered 285, 286, 287, 305,
306, 307, 308, 309, 313, 314, 315, 316,
317, 334, 335, 336, 337 do not exist.

Revised "Jezzer Plan No. 280-71"
Scale 1"=20' Drawn by LF