

SECTION No. 3

DEDHAM STREET

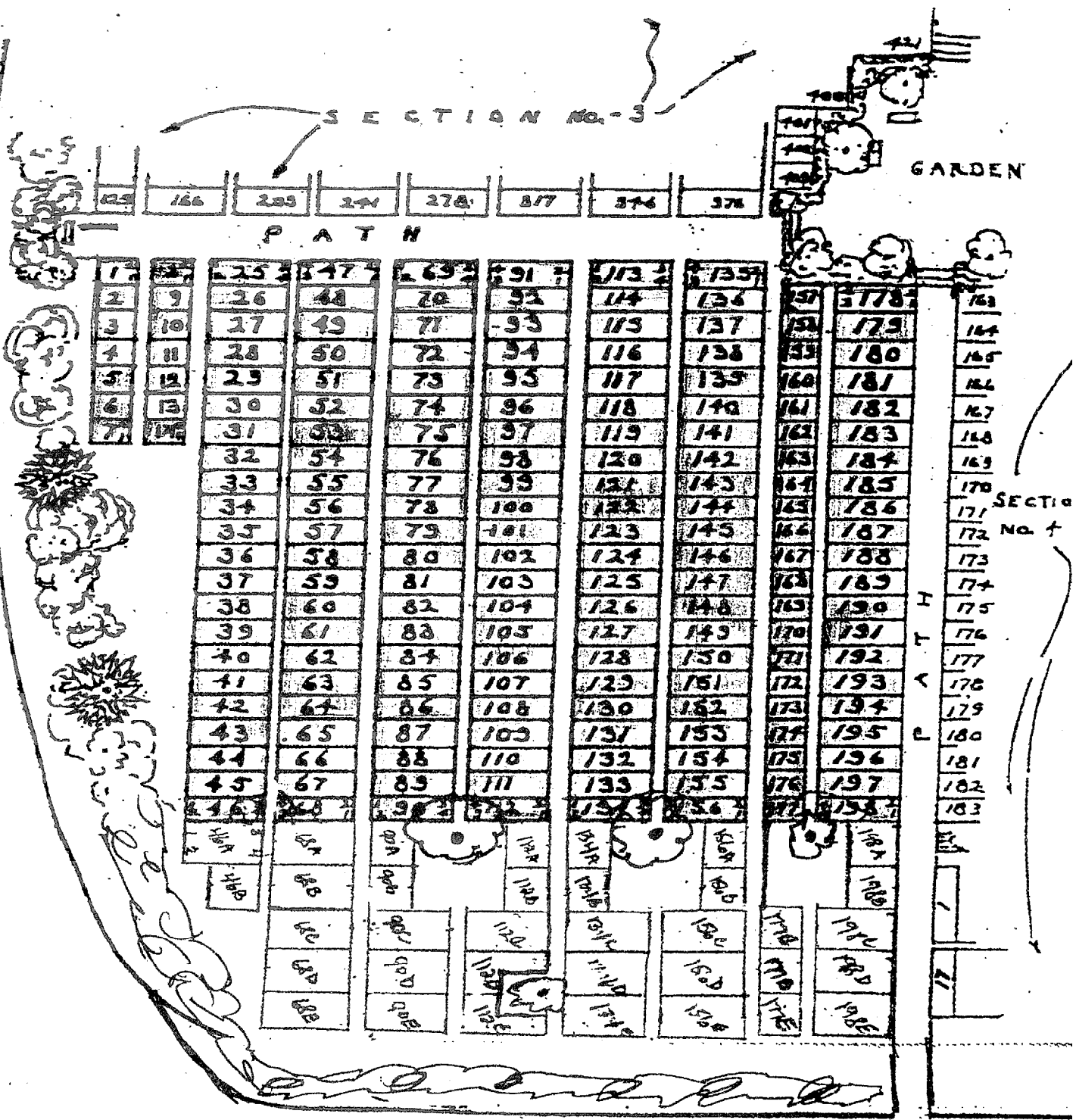

MAIN EXIT

ERETZ SHALOM

SECTION-2  
SHARON MEMORIAL  
PARK -  
SHARON, MASS.

BARTON  
BOSTON, MASS

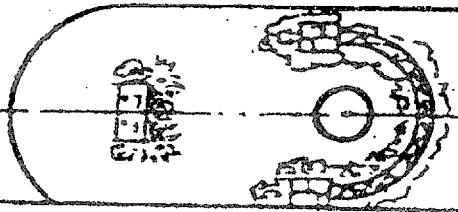

DATE - 6-27-56 REVISED - 7-19-57  
REVISED - 10-17-58

6/20/00